

## TERMOFLEX® MINERAL

external integrated insulation system, based on mineral wool for thermal insulation of buildings and high grade fire and noise protection



### Scope of use

TERMOFLEX® MINERAL is a thermal insulation system, composed of hard stone wool slabs with integrated double-layer characteristics and impregnated with organic resin. The plates have different thicknesses depending on the specific conditions and requirements. All components are practically tested and cautiously selected, complementing each other in an optimal way and applied in a system, providing durability, efficiency and seamless exploitation.

For the exclusive use of mineral components (mineral wool, mineral adhesive and reinforcing mortars and mineral type finish plaster) the system is extremely diffusion open, robust, durable and non-combustible. Its high vapor permeability ensures healthy indoor environment, allowing the construction to "breathe", thus effectively preventing accumulation of condensates and mold, both in the construction and the premises.

TERMOFLEX® MINERAL has very good thermal insulation characteristics in all seasons and protects premises against overcooling in winter and overheating in summer, saving up to 60-70% of heating and cooling expenditures. It is extremely resistant to aging, weathering and fissures. A proper installation ensures longer life of outer walls, its hydrophobic properties and mechanical resistance.

The ENERGY IN COLORS tinting system offers an array of opportunities for individual shaping of finishing coat of the thermal insulation by color and structure, offering a choice of over 2080 colors and five structure types of decorative plaster.

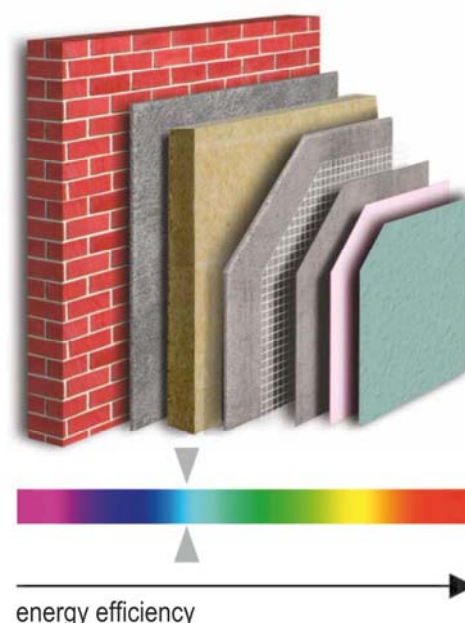

### Areas of application

TERMOFLEX® MINERAL is suitable for insulating facades of buildings to which higher class requirements for fire safety are placed and those of increased risk of damage resulting from fire. It is recommended for use in areas with large temperature variations and long winters.

## Properties

proper thermal characteristics	resistant to contamination and microbial attacks
reducing heating and cooling costs	resistant to UV-rays and aging
high fire protection (class A1)	color stability and durability
very high permeability, which allows "breathing" of the construction	quick mounting and easy structuring
good noise protection	10 years warranty

## Components

### THERMO INSULATION MATERIAL with thickness up to 25 cm

- **ROCKWOOL® Frontrock MAX E** (or another stone wool facade insulation material)  
 (hard stone wool slabs with integrated double-layer characteristics, impregnated with organic resin, used as thermal- and sound insulation and fire protection for external thermal insulation combined (multipurpose) systems)

### FIXING OF THE THERMO INSULATION PLATES

- **TERMOFLEX® ADHESIVE AND REINFORCING MORTAR FOR MINERAL WOLL**  
 (adhesive mortar reinforced with fibers for bonding and plastering mineral wool boards for thermo-insulation of buildings)
- **ANCHORS WITH METAL PIN**  
 (hammer in anchors with metal pin for mechanical montage of plates made of polystyrene, hard polyurethane, mineral and wood wool)

### ARMING PLASTER

- **REINFORCEMENT FIBERGLASS MESH**  
 (alkali proof fiber glass mesh for producing an armed mortar coat in an thermal insulation system and retrofitting of cracks on facade surfaces)
- **TERMOFLEX® REINFORCING MORTAR FOR EPS & XPS**  
 (construction reinforcing mortar for bonding and plastering thermo-insulation boards from expanded (EPS) and extruded (XPS) polystyrene when thermo insulating buildings)

### PRIMER COVERING

- **TERMOFLEX® COLOUR PRIMER**  
 (coloured steam permeable primer, which penetrates within the base and improves adhesion prior to plaster application and facade painting)

### FINISH COVERING

- **TERMOFLEX® PRO SOLID**  
 (paste-like silicate-silicone plaster, with great resistance to mechanical loads, aging and atmospheric influences, combining the advantages of the silicate and silicone plasters)

## ADDITIONAL COMPONENTS

- **CORNER PROFILES, CORNER PROFILES WITH DRIP CAP, LUTING PROFILES AND ACCESSORIES FOR THERMAL INSULATION SYSTEM**  
 (for watertight shaping and arming the edges of thermal insulation systems in the area of edges, corners, around windows, doors etc. and their contact with other elements)
- **ACCESSORIES FOR SET OFF AND CLOSING PROFILES**  
 (accessories for precise and reliable shaping of the set off and its integrating into a thermal insulation system)

## Instructions for use

For more information and detailed description of all necessary operations, which should be performed refer to “Technological instruction for constructing thermal insulation systems TERMOFLEX® and TERAPOR®.

### Attention!

The installation of the thermal insulation should be performed at dry weather at temperature of the base and environment from +5°C to +30°C and air humidity below 65%.

## Classification

Complies with the requirements of European and Bulgarian standards and measures up to:

European Standard	Type	Testing protocols
ETAG 004	-	
EN 13500	-	
EN 13501-1	A1 (Euro class)	

## Designation code of the thermo insulation material

**MW – EN 13162 – T5 – DS(T+) – DS(TH) – CS(10)20 – TR10 PL(5)250 – WS – WL(P) – MU1**

The information contained in the current document is based on our knowledge and recent technical achievements and experience that we have at the time of the last version. The technical recommendations concerning application that we offer in order to facilitate buyers and those working with our products are non-binding and are neither grounds for legal contract relations, or for additional obligations resulting from the purchase contract. They do not dispense buyers from the necessity to verify products application according to the instructions for every specific use. We as manufacturers guarantee the quality of the product, but cannot influence the circumstances and methods of its use. Application of the product should be performed by qualified personnel.